

The Estate Agent People Recommend



14 Eastview Road,
Wargrave
RG10 8BH

£595,000



Wentworth Estate Agents have pleasure to offer a DETACHED THREE BEDROOM BUNGALOW with NO ONWARD CHAIN in a quiet road within the beautiful village of Wargrave.

The property is within walking distance to the local shop, recreation ground and bowling green. Wargrave is located on the river Thames, benefiting with a local train station serving Henley-on-Thames and Twyford. Wargrave high street offers pubs, restaurants, coffee shop and dentist. The M4 is also less than 10 miles away providing easy access to the Heathrow and motorway network.

Accommodation comprises of large entrance hall, living room, kitchen, three bedrooms, family bathroom and conservatory.

Further benefits include gas central heating, stairs to the loft area, parking for two cars, large laid to lawn private garden.

The property does require modernisation throughout.

EPC - D

NO ONWARD CHAIN

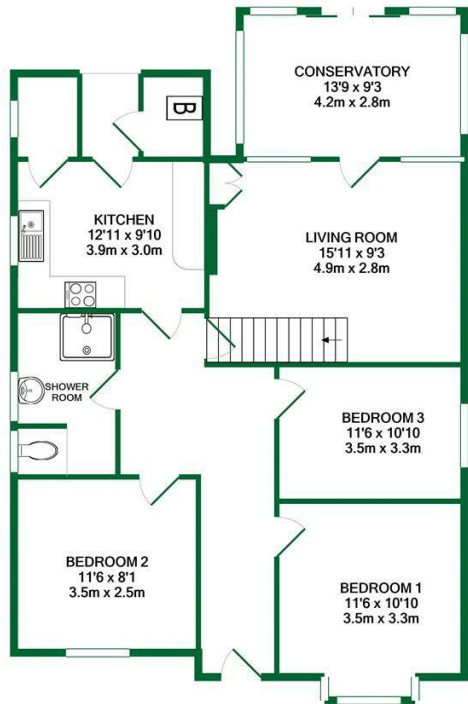

GROUND FLOOR

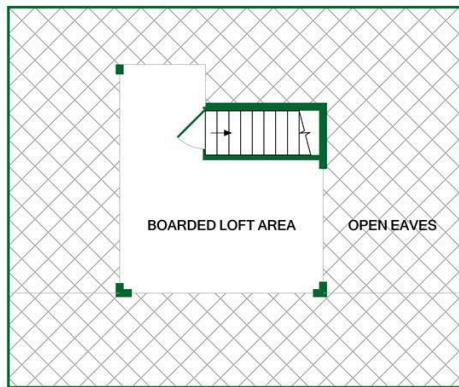

PART BOARDED LOFT SPACE

TOTAL APPROX. FLOOR AREA 797 SQ.FT. (74.0 SQ.M.)

Whilst every attempt has been made to ensure the accuracy of the floor plan contained here, measurements of doors, windows, rooms and any other items are approximate and no responsibility is taken for any error, omission, or mis-statement. This plan is for illustrative purposes only and should be used as such by any prospective purchaser. The services, systems and appliances shown have not been tested and no guarantee as to their operability or efficiency can be given.
Made with Metropix ©2020



ACCOMMODATION

- THREE BEDROOM DETACHED BUNGALOW
- GOOD SIZE GARDEN
- PARKING FOR 2 CARS
- IN A QUIET LOCATION
- WALKING DISTANCE TO THE PARK AND SHOP
- WITHIN A BEAUTIFUL VILLAGE ON THE RIVER THAMES
- NO ONWARD CHAIN

